

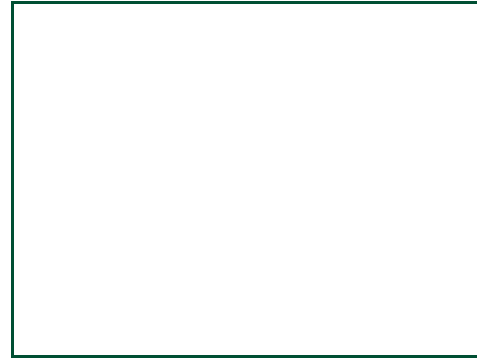

Brampton Valley Lane
Chapel Brampton, Northamptonshire

oriordanbond
SALES & LETTINGS



GROUND FLOOR
593 sq.ft. (55.1 sq.m.) approx.

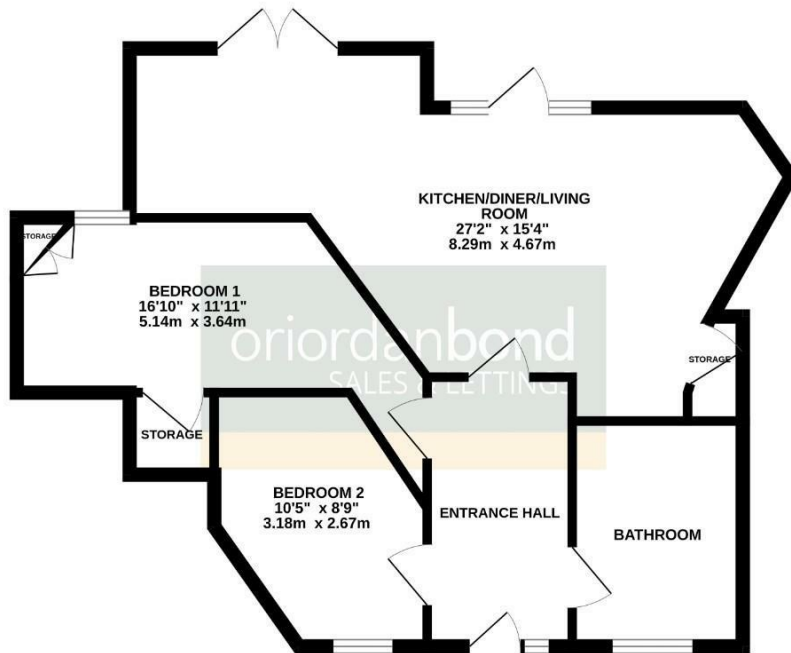

TOTAL FLOOR AREA : 593 sq.ft. (55.1 sq.m.) approx.

Whilst every attempt has been made to ensure the accuracy of the floorplan contained here, measurements of doors, windows, rooms and any other items are approximate and no responsibility is taken for any error, omission or mis-statement. This plan is for illustrative purposes only and should be used as such by any prospective purchaser. The services, systems and appliances shown have not been tested and no guarantee as to their operability or efficiency can be given.
Made with: Metreplan 02/20

Brampton Valley Lane

Chapel Brampton

NN6 8GA

PRICE £200,000

Offered for sale with no onward chain is this two bedroom bungalow located in the popular Brampton View Care Village. Constructed by Messrs Avery Care Homes, the property offers independent living for the over 55's with access to an on-site manager and staff.

The accommodation comprises large entrance hall, two double bedrooms which are serviced by a fully tiled bathroom and a large open plan kitchen/sitting/dining room with access to the rear garden. Outside is a small low maintenance garden with patio area, maintained communal grounds and one allocated parking space. Further benefits include uPVC double glazing throughout and electric heating. (A/593/S)

Leasehold Information: Lease Remaining - 281 years (as of 2026) / Ground Rent - £155 per annum / Service Charge - £4,200 per annum (includes water and building insurance)

Additional information

- Council Tax Band: D
- Energy Efficiency Rating:

Viewing

Viewing strictly by appointment – details below

Disclaimer

O'Riordan Bond Estate Agents Limited has not tested apparatus, equipment, fittings or services and so cannot verify they are in working order. The buyer is advised to obtain verification from their solicitor or surveyor.

O'Riordan Bond Kingsthorpe Sales

01604 722007

kingsthorpe@oriordanbond.co.uk

